

Instructivo para agregar usuarios

- Presionar **menú** . (En pantalla, izquierda arriba)
- Luego el dispositivo comprobara al administrador por rostro, huella, tarjeta o código.
- Ingresamos al menú, seleccionamos **"User"**, imagen 1.
- Asignamos nombre **"Name"** y privilegios **"Level"** *, imagen 2.
- Registramos métodos de acceso para el usuario, imagen 3.
- Salir con **X** (Derecha arriba) Usuario creado.

*Niveles: "User", para empleados. "Administrador", para gestión del dispositivo.

Imagen 1



Imagen 2



A screenshot of the "Enroll" screen. It has a close button (X) in the top right corner. The screen contains the following fields: "User ID" (text input), "Part" (dropdown menu with "[1]" selected), "Name" (text input), and "Level" (dropdown menu with "User" selected). At the bottom, there are "OK" and "Cancel" buttons.

Imagen 3

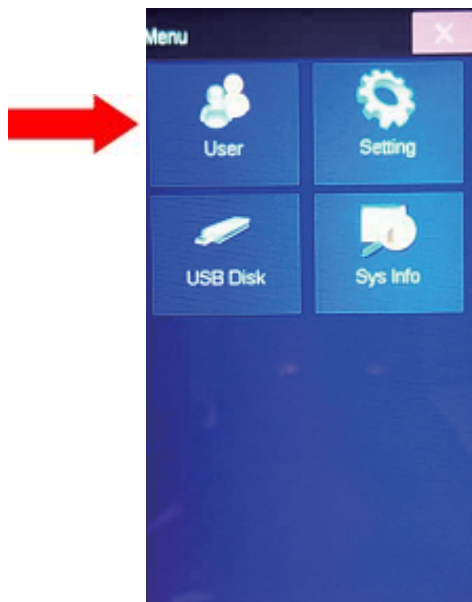

A screenshot of the "Enroll" screen showing the "Enroll : User 0000000001" header and a list of access methods. The list includes: "Face" (with a person icon), "Fingerprint" (with a fingerprint icon), "Card" (with a card icon), "Password" (with a lock icon), "Photo" (with a photo icon), "Verification Mode" (with "System Default" selected), "User Timezone" (with a right arrow), and "Fingerprint Alarm" (with a right arrow).