



DATASHEET  
**CY-ACS-303**



## Fingerprint Access Control System

### User Manual



- Due to continuous updating of our products ,all functions are on the basis of real product, Our company can't promise the real product is same as the default mentioned.

## I.Product Overview and Installation Instruction

### Applicable Models

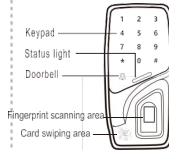

S.N	Functions
1	Capacitive fingerprint sensor
2	Built-in card reader
3	Fingerprint/card verification
4	Digital keypad
5	Tamper alarm
6	Output
7	Installation

Operating Environment:  
 Environmental temperature: -20°C~+50°C  
 Relative humidity: 95%  
 Operating Voltage & Current:  
 Input DC: +12V  
 Standby current:≤60mA  
 Operating current:≤120mA

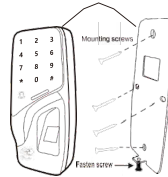

-1-

## II.Pressing Fingerprint

Suggested finger: index finger, middle finger or ring finger instead of thumb or little finger

### 1) Correct method for pressing fingerprint

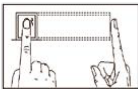

Use the finger to evenly press the center of fingerprint area

### 2) Wrong methods for pressing fingerprint

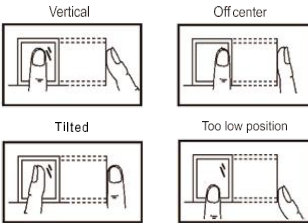

- Please press fingerprint correctly for verification, and improper operation might result in poor performance of this device

-2-

## III.Ports & Wiring Diagram

### Wiring Schematic Diagram A

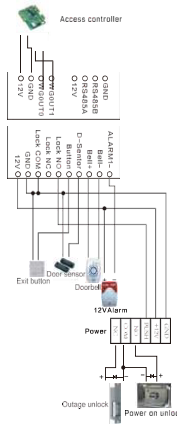

### Wiring Schematic Diagram B

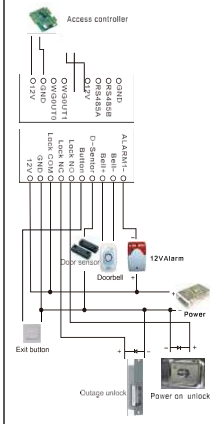
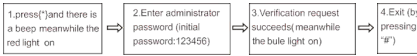

Diagram A instructions is electricity lock, using a special power supply access of the connection mode; Diagram B instructions is electricity lock and fingerprint access to share a power supply. Special attention - to protect the power supply, locks needed to mount a diode in the positive and negative ends, and the white side marked on the diode connects to the electric lock positive.

-3-

## IV - Administrator Operation



Remarks: once verification request succeeds, it is allowed to register administrator and the initial password will be out of use

### 4.1 Registering administrator

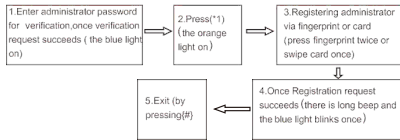

Remarks:

- Administrator can only be registered 5 groups, and only fingerprint and card are available.
- In case administrator quantity reaches the maximum value, they will be cleared based on the administrator number from small to large automatically.

### 4.2 Missing administrator password

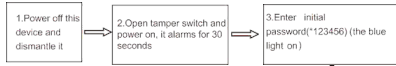

## VII. Deleting Users

### 7.1 Delete a User

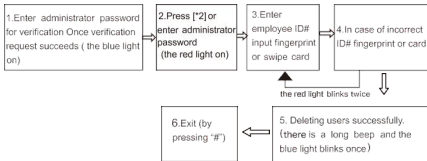
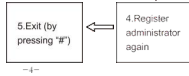

### 7.2 Delete All Users

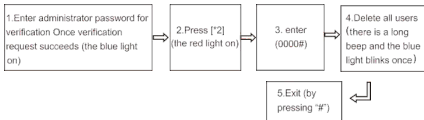

## VIII: Access Control System Management

### 8.1 System Settings

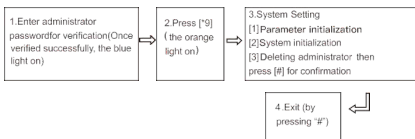

## V. Registering User

### 5.1 Register Users Automatically

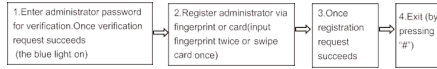

### 5.2 Register Users Manually

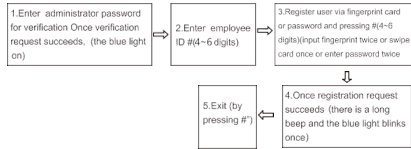

## VI. User Operation

### 6.1 User Verification via Fingerprint or Card

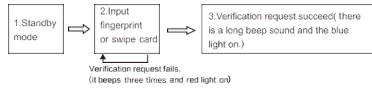

### 6.2 User Verification via Password

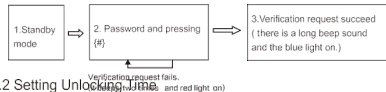

### 8.2 Setting Unlocking Time

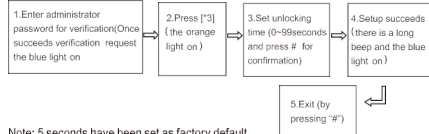

## IX: USB Pen driver registered information saving

(Upload the registered information in the USB pen driver to the device,

Download the registered information in the device to USB pen driver)

Take the back cover of the device apart, insert the USB convert cable into mini usb port of the mainboard, then insert the USB pen driver into the USB cable, then press \*\*\*, Enter administrator password (original password 123456), or press administrator fingerprint, swipe administrator card, blue light on and meanwhile device rings. At this time, the device will process two procedures, first is uploading the registered information in the pen driver to device (if there is no registered information, it will not upload), and then download registered information in the device to USB pen driver. When the blue light off and ringing stopped, the data copied successfully.

## X: Packing

Description	Specifications	Quantity	Remarks
Device		1	
Packaging box		1	
Plastic plugs	4mmx28mm	4	For mounting and fixing
Self-tapping screws	4mmx28mm	4	For mounting and fixing
Diode	1n4007	2	

**CYGNUS**  
electronics

